

MOTEURS, MOTEURS-FREIN & GLISSIERES



SOMMAIRE

- Moteurs MF-02
- Moteurs-Frein & Moteurs-frein avec codeur intégré..... MF-04
- Glissières..... MF-10

Bride B3

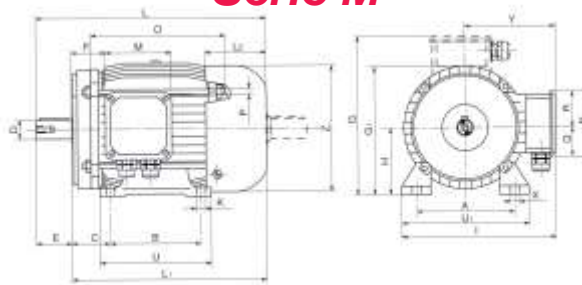

Taille	Dimensions en mm																								
	A	B	C	D	E	F	G	G ₁	H	I	L	L ₁	L ₂	M	N	O	P	Q	R	U	U ₁	K	X	Y	Z
56	90	71	36	9	20	30	166	110	56	162	187	167	54	92	92	115	M4	34	58	90	108	6	11	110	110
63	100	80	40	11	23	25	178	125	63	175	216	193	61	92	92	138	M5	34	58	105	120	7	12	115	123
71	112	90	45	14	30	25	195	139	71	192	245	215	71	92	92	138	M5	40	52	108	136	7	12	124	138
80	125	100	50	19	40	30	221	157	80	218	275	235	75	108	108	168	M5	48	60	125	154	9.5	17.5	141	156
90S	140	100	56	24	50	33	236	177	90	233	300	250	85	108	108	168	M5	48	60	130	174	9.5	17.5	146	176
90L	140	125	56	24	50	33	236	177	90	233	325	275	85	108	108	194	M5	48	60	155	174	9.5	17.5	146	176
100	160	140	63	28	60	40	257	196	100	253	365	305	95	108	108	210	M6	48	60	175	192	11.2	21.2	157	194
112	190	140	70	28	60	45	281	220	112	282	385	325	99	108	108	224	M6	48	60	175	226	11.2	21.2	169	220
132S	216	140	89	38	80	50	327	260	132	325	460	380	117	122	122	241	M8	61	61	180	260	11.2	21.2	195	256
132L	216	178	89	38	80	50	327	260	132	325	490	410	117	122	122	280	M8	61	61	218	260	11.2	21.2	195	256
160S	254	210	108	42	110	90	392	315	160	390	600	490	136	185	172	330	M10	86	86	260	318	13	23	232	310
160L	254	254	108	42	110	90	392	315	160	390	644	534	136	185	172	374	M10	86	86	304	318	13	23	232	310

Sous réserve de modifications.

Bride B5

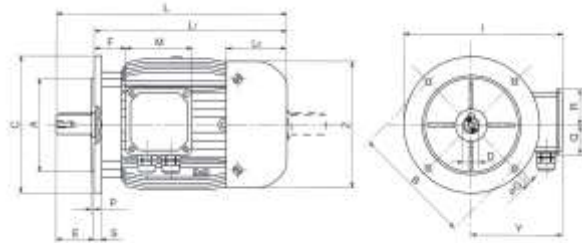

Taille	Dimensions en mm																		
	A	B	C	D	E	F	G	I	L	L ₁	L ₂	M	N	P	Q	R	S	Y	Z
56	80	100	120	9	20	30	7	170	187	167	54	92	92	3	34	58	9	110	110
63	95	115	140	11	23	25	10	185	216	193	61	92	92	3	34	58	10	115	123
71	110	130	160	14	30	25	10	204	245	215	71	92	92	3.5	40	52	10	124	138
80	130	165	200	19	40	30	12	241	275	235	75	108	108	3.5	48	60	10	141	156
90S	130	165	200	24	50	33	12	246	300	250	85	108	108	3.5	48	60	10	146	176
90L	130	165	200	24	50	33	12	246	325	275	85	108	108	3.5	48	60	10	146	176
100	180	215	250	28	60	40	14.5	282	365	305	95	108	108	4	48	60	15	157	194
112	180	215	250	28	60	45	14.5	295	385	325	99	108	108	4	48	60	15	170	220
132S	230	265	300	38	80	50	14.5	345	460	380	117	122	122	4	61	61	18	195	256
132L	230	265	300	38	80	50	14.5	345	490	410	117	122	122	4	61	61	18	195	256
160S	250	300	350	42	110	90	18.5	407	600	490	136	185	172	5	86	86	14	232	310
160L	250	300	350	42	110	90	18.5	407	644	534	136	185	172	5	86	86	14	232	310

Sous réserve de modifications.

Bride B14

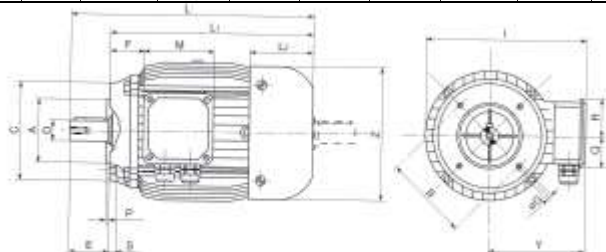

Taille	Dimensions en mm																		
	A	B	C	D	E	F	G	I	L	L ₁	L ₂	M	N	P	Q	R	S	Y	Z
50L	50	65	80	9	20	25	M5	128	163	143	45	64	64	2	32	32	7	80	98
56	50	65	80	9	20	30	M5	165	187	167	54	92	92	2	34	58	8.5	110	110
63	60	75	90	11	23	25	M5	176	216	193	61	92	92	2	34	58	9	115	123
71	70	85	105	14	30	25	M6	192	245	215	71	92	92	2.5	40	52	12	124	138
80	80	100	120	19	40	30	M6	218	275	235	75	108	108	3	48	60	12	141	156
90S	95	115	140	24	50	33	M8	233	300	250	85	108	108	3	48	60	15	146	176
90L	95	115	140	24	50	33	M8	233	325	275	85	108	108	3	48	60	15	146	176
100	110	130	160	28	60	40	M8	253	365	305	95	108	108	3.5	48	60	16.5	157	194
112	110	130	160	28	60	45	M8	278	385	325	99	108	108	3.5	48	60	16.5	170	220
132S	130	165	200	38	80	50	M10	323	460	380	117	122	122	3.5	61	61	18	195	256
132L	130	165	200	38	80	50	M10	323	490	410	117	122	122	3.5	61	61	18	195	256
160S	180	215	252	42	110	90	M12	387	600	490	136	185	172	4	86	86	18	232	310
160L	180	215	252	42	110	90	M12	387	644	534	136	185	172	4	86	86	18	232	310

Sous réserve de modifications.

Série BA

B3

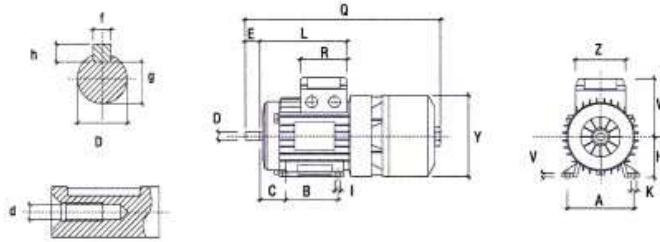

B5

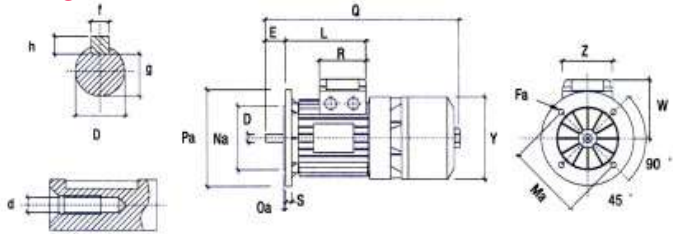

B14

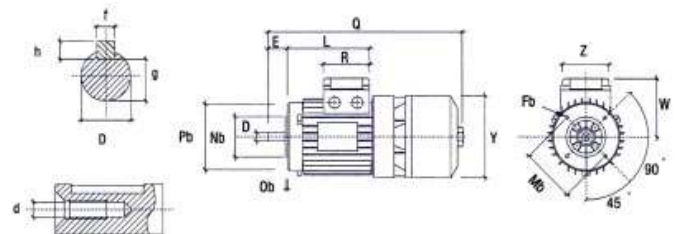

B3 - Tailles 160 à 225

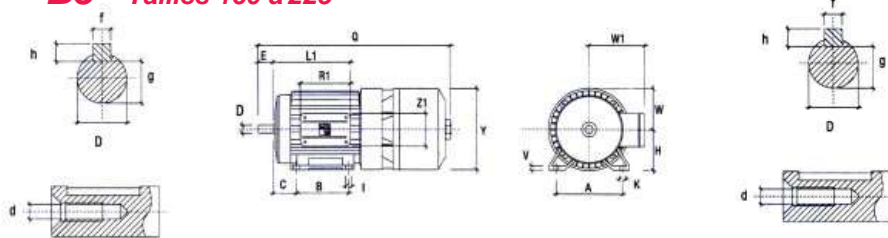

Boîte à bornes double

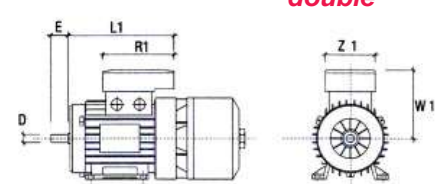

Dimensions en mm	Tailles													
	71	80	90S	90L	100L	112M	132S	132M	160M	160L	180L	200L	225S	225M
A	112	125	140	140	160	190	216	216	254	254	279	318	356	356
B	90	100	100	125	140	140	140	178	210	254	279	305	286	311
C	45	50	56	56	63	70	89	89	108	108	121	133	149	149
D*	14	19	24	24	28	28	38	38	42	42	48	55	60	60
d	M5	M6	M8	M8	M10	M10	M12	M12	M16	M16	M16	M16	M16	M16
E*	30	40	50	50	60	60	80	80	110	110	110	110	140	140
Fa	9.5	11.5	11.5	11.5	14	14	14	14	18	18	18	18	18.5	18.5
Fb	M6	M6	M8	M8	M8	M8	M10	M10						
f	5	6	8	8	8	8	10	10	12	12	14	16	18	18
g	11	15.5	20	20	24	24	33	33	37	37	42.5	49	53	53
H	71	80	90	90	100	112	132	132	160	160	180	200	225	225
h	5	6	7	7	7	7	8	8	8	8	9	10	11	11
I	7	10	10	10	12	12	12	12	14.5	14.5	15	18.5	18	18
K	10.5	14	14	14	16	16	22	22	24	24	24	30	33	33
L	148	162	171	196	217	229								
L1	184	194	207	232	254	262	294	339	373	395	420	446	452	464.5
Ma	130	165	165	165	215	215	265	265	300	300	300	350	400	400
Mb	85	100	115	115	130	130	165	165						
Na	110	130	130	130	180	180	230	230	250	250	250	300	350	350
Nb	70	80	95	95	115	115	130	130						
Oa	3.5	3.5	3.5	3.5	4	4	4	4	5	5	5	5	5	5
Ob	2.5	3	3	3	3.5	3.5	3.5	3.5						
Pa	160	200	200	200	250	250	300	300	350	350	350	400	450	450
Pb	105	120	140	140	160	160	200	200						
Q	344	380	412	436	487	505	606	644	732	776	860	885	977	1002
QBAF/BAPV**	368	403	436	460	511	531	634	672	765	809	907	932	1014	1035
R	80	80	98.5	98.5	98.5	98.5								
R1	135	135	170	170	170	170	199	199	268	268	268	268	268	268
S	10	12	12	12	14	14	15	15	15	15	15	15	16	16
V	8	9.5	10.5	10.5	12.5	13.5	16	16	21	21	24	24	30	30
W	105	113	127	127	138	158			165	165	188	188	215	215
W1	121	130	148	148	162	176	215	215	246	246	266	266	321.5	321.5
Y	145	160	180	180	196	218	265	265	324	324	357	357	430	430
Z	75	75	98.5	98.5	98.5	98.5								
Z1	86	86	112	112	112	112	151	151	167	167	167	167	167	167

* : Pour les tailles 225S & 225M : D=55 et E=110

Sous réserve de modifications

** : Dimension de Q pour les séries BAF et BAPV

NB : Dimensions des presse-étoupes : - M20 de la taille 71 à 80
- M25 de la taille 90 à 112

- M32 pour la taille 132
- PG29 de la taille 160 à 200

- M50 pour la taille 225

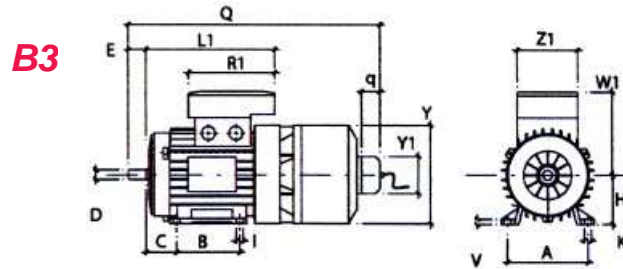

B5

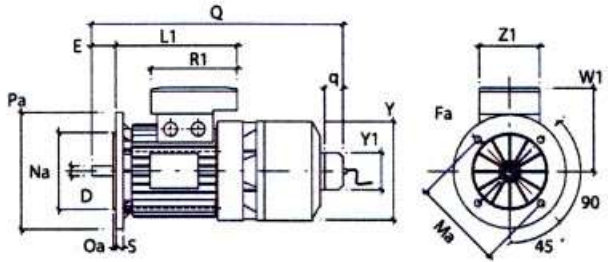

B14

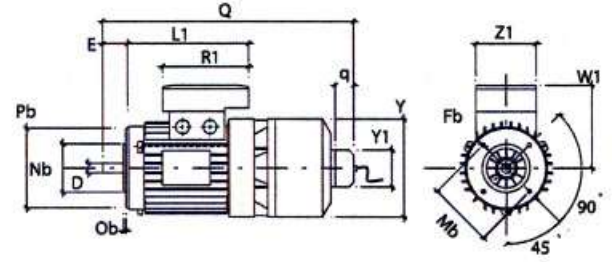

B3 - Tailles 160 à 225

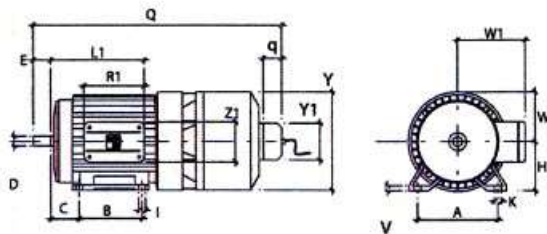

Arbre de sortie

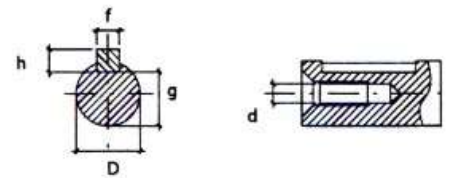

Dimensions en mm	Tailles													
	71	80	90S	90L	100L	112M	132S	132M	160M	160L	180L	200L	225S	225M
A	112	125	140	140	160	190	216	216	254	254	279	318	356	356
B	90	100	100	125	140	140	140	178	210	254	279	305	286	311
C	45	50	56	56	63	70	89	89	108	108	121	133	149	149
D*	14	19	24	24	28	28	38	38	42	42	48	55	60	60
d	M5	M6	M8	M8	M10	M10	M12	M12	M16	M16	M16	M16	M16	M16
E*	30	40	50	50	60	60	80	80	110	110	110	110	140	140
Fa	9.5	11.5	11.5	11.5	14	14	14	14	18	18	18	18	18.5	18.5
Fb	M6	M6	M8	M8	M8	M8	M10	M10						
f	5	6	8	8	8	8	10	10	12	12	14	16	18	18
g	11	15.5	20	20	24	24	33	33	37	37	42.5	49	53	53
H	71	80	90	90	100	112	132	132	160	160	180	200	225	225
h	5	6	7	7	7	7	8	8	8	8	9	10	11	11
I	7	10	10	10	12	12	12	12	14.5	14.5	15	18.5	18	18
K	10.5	14	14	14	16	16	22	22	24	24	24	30	33	33
L1	184	194	207	232	254	262	294	339	373	395	420	446	452	464.5
Ma	130	165	165	165	215	215	265	265	300	300	300	350	400	400
Mb	85	100	115	115	130	130	165	165						
Na	110	130	130	130	180	180	230	230	250	250	250	300	350	350
Nb	70	80	95	95	115	115	130	130						
Oa	3.5	3.5	3.5	3.5	4	4	4	4	5	5	5	5	5	5
Ob	2.5	3	3	3	3.5	3.5	3.5	3.5						
Pa	160	200	200	200	250	250	300	300	350	350	350	400	450	450
Pb	105	120	140	140	160	160	200	200						
Q	415	451	483	507	558	576	677	715	803	847	931	856	1082	1103
q	76	76	76	76	76	76	76	76	76	76	76	76	112	112
R1	135	135	170	170	170	170	199	199	268	268	268	268	268	268
S	10	12	12	12	14	14	15	15	15	15	15	15	16	16
V	8	9.5	10.5	10.5	12.5	13.5	16	16	21	21	24	24	30	30
W									165	165	188	188	215	215
W1	121	130	148	148	162	176	215	215	246	246	266	266	321.5	321.5
Y	145	160	180	180	196	218	265	265	324	324	357	357	430	430
Y1	121	121	121	121	121	121	121	121	121	121	121	121	158	158
Z1	86	86	112	112	112	112	151	151	167	167	167	167	167	167

Sous réserve de modifications

* : Pour les tailles 225S & 225M : D=55 et E=110



MOTEURS-FREIN ASYNCHRONES TRIPHASES

Série BM



B3

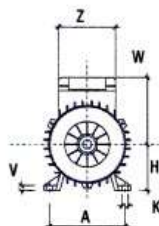
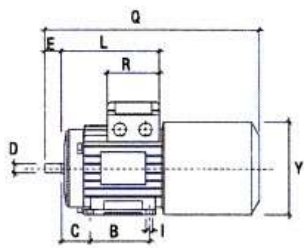

B5

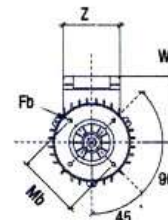
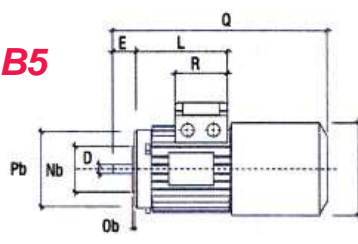

B3
Taille 160

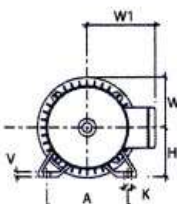
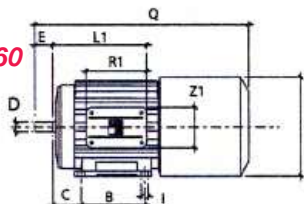

B14

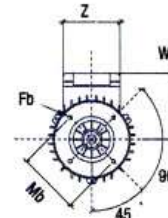
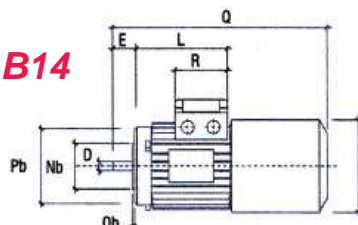

Boîte à bornes double

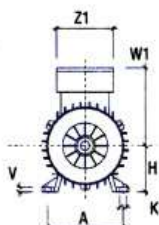
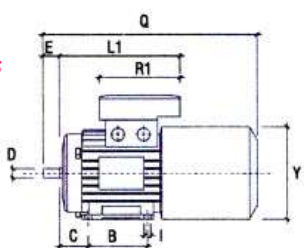

Arbre de sortie

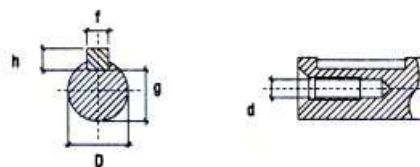

Dimensions en mm	Tailles											
	56	63	71	80	90S	90L	100L	112M	132S	132M	160M	160L
A	90	100	112	125	140	140	160	190	216	216	254	254
B	71	80	90	100	100	125	140	140	140	178	210	254
C	36	40	45	50	56	56	63	70	89	89	108	108
D	9	11	14	19	24	24	28	28	38	38	42	42
d	M3	M4	M5	M6	M8	M8	M10	M10	M12	M12	M16	M16
E	20	23	30	40	50	50	60	60	80	80	110	110
Fa	6.6	9.5	9.5	11.5	11.5	11.5	14	14	14	14	18	18
Fb	M5	M5	M6	M6	M8	M8	M8	M8	M10	M10		
f	3	4	5	6	8	8	8	8	10	10	12	12
g	7.2	8.5	11	15.5	20	20	24	24	33	33	37	37
H	56	63	71	80	90	90	100	112	132	132	160	160
h	3	4	5	6	7	7	7	7	8	8	8	8
I	6	7	7	10	10	10	12	12	12	12	14.5	14.5
K	11	10.5	10.5	14	14	14	16	16	22	22	24	24
L	119	130	145	162	171	196	217	229	255	293		
L1		166	182	194	207	232	254	262	294	339	373	395
Ma	100	115	130	165	165	165	215	215	265	265	300	300
Mb	65	75	85	100	115	115	130	130	165	165		
Na	80	95	110	130	130	130	180	180	230	230	250	250
Nb	50	60	70	80	95	95	110	110	130	130		
Oa	3	3	3.5	3.5	3.5	3.5	4	4	4	4	5	5
Ob	2.5	2.5	2.5	3	3	3	3.5	3.5	3.5	3.5		
Pa	120	140	160	200	200	200	250	250	300	300	350	350
Pb	80	90	105	120	140	140	160	160	200			
Q	230	260	295	334	360	385	435	470	565	604	690	734
R	75	80	80	80	98.5	98.5	98.5	98.5	108	108		
R1		135	135	135	170	170	170	170	199	199	268	268
S	8	10	10	12	12	12	14	14	15	15	15	15
V	7	7	8	9.5	10.5	10.5	12.5	13.5	16	16	21	21
W	93	97	105	113	127	127	138	158	198	198	155	155
W1		111	121	130	148	148	162	176	210	210	246	246
Y	110	121	136	153	178	178	198	219.5	255	255	293	293
Z	75	75	75	75	98.5	98.5	98.5	98.5	108	108		
Z1		86	86	86	112	112	112	112	151	151	167	167

Sous réserve de modifications

NB : Dimensions des presse-étoupes : - M16 de la taille 56 à 63
- M20 de la taille 71 à 80
- M25 de la taille 90 à 112

- M32 pour la taille 132
- PG29 pour la taille 160

B3

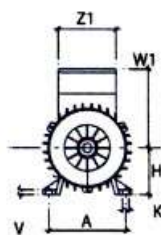
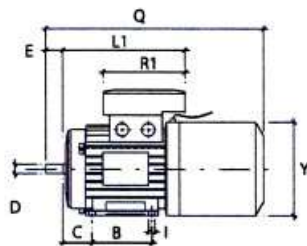

B5

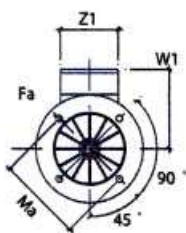
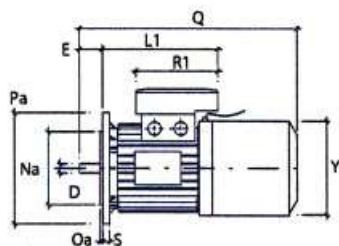

B14

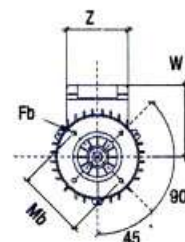
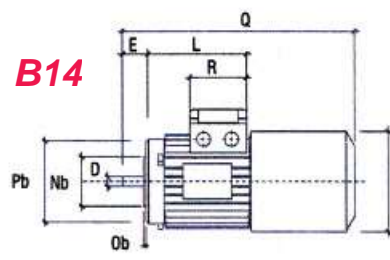

B3
Taille 160

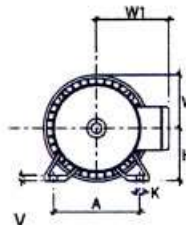
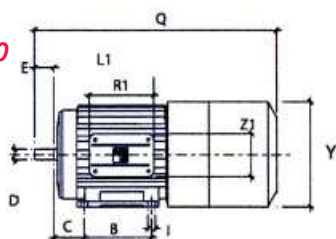

Arbre de sortie

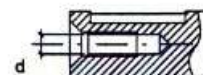
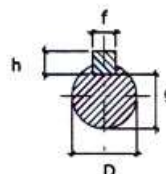

Dimensions en mm	Tailles										
	63	71	80	90S	90L	100L	112M	132S	132M	160M	160L
A	100	112	125	140	140	160	190	216	216	254	254
B	80	90	100	100	125	140	140	140	178	210	254
C	40	45	50	56	56	63	70	89	89	108	108
D	11	14	19	24	24	28	28	38	38	42	42
d	M4	M5	M6	M8	M8	M10	M10	M12	M12	M16	M16
E	23	30	40	50	50	60	60	80	80	110	110
Fa	9.5	9.5	11.5	11.5	11.5	14	14	14	14	18	18
Fb	M5	M6	M6	M8	M8	M8	M8	M10	M10		
f	4	5	6	8	8	8	8	10	10	12	12
g	8.5	11	15.5	20	20	24	24	33	33	37	37
H	63	71	80	90	90	100	112	132	132	160	160
h	4	5	6	7	7	7	7	8	8	8	8
I	7	7	10	10	10	12	12	12	12	14.5	14.5
K	10.5	10.5	14	14	14	16	16	22	22	24	24
L1	166	182	194	207	232	254	262	294	339	373	395
Ma	115	130	165	165	165	215	215	265	265	300	300
Mb	75	85	100	115	115	130	130	165	165		
Na	95	110	130	130	130	180	180	230	230	250	250
Nb	60	70	80	95	95	110	110	130	130		
Oa	3	3.5	3.5	3.5	3.5	4	4	4	4	5	5
Ob	2.5	2.5	3	3	3	3.5	3.5	3.5	3.5		
Pa	140	160	200	200	200	250	250	300	300	350	350
Pb	90	105	120	140	140	160	160	200	200		
Q	310	345	384	410	435	485	520	625	664	690	734
R1	135	135	135	170	170	170	170	199	199	268	268
S	10	10	12	12	12	14	14	15	15	15	15
V	7	8	9.5	10.5	10.5	12.5	13.5	16	16	21	21
W										155	155
W1	111	121	130	148	148	162	176	210	210	246	246
Y	121	136	153	178	178	198	219.5	255	255	293	293
Z1	86	86	86	112	112	112	112	151	151	167	167

Sous réserve de modifications



GLISSIERES EN FONTE **PMG**



PMG/S

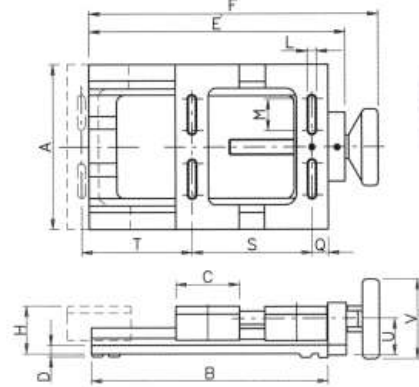
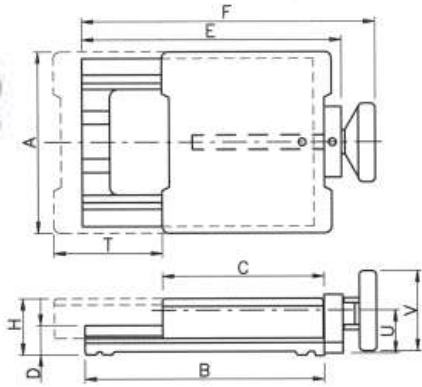

PMG/D

Taille	Moteur	Ajustement		Dimensions en mm														Poids kg
		S	T	A	B	C	D	E	F	G	H	L	M	Q	R	U	V	
PMG/S 1	56 A	-	-															
	63M	-	-	145	185	155	40	210	245	105	50	-	-	-	85	35	80	3.5
	71M	-	-															
	80M	-	-															
PMG/S 2	80M	-	-															
	90S	-	-	175	230	200	28	255	290	112	50	-	-	-	105	39	80	7.5
	90L	-	-															
PMG/S 3	100L	-	-															
	112M	-	-	210	305	257	30	325	360	142	60	-	-	-	130	48	100	10.5
	132S	-	-															
PMG/S 4	132M	-	-															
	160M	-	-															
	160L	-	-	355	400	387	72	460	505	245	88	-	-	-	150	65	125	28.5
	180M	-	-															
	180L	-	-															
PMG/D 1	71M	112	100															
	80M	125	87	170	230	67	28	255	290	112	50	10	43	17	-	39	80	5
	90S	1240	72															
PMG/D 2	90S	140	120															
	90L	140	120	215	305	85	30	325	360	142	60	12	60	22	-	48	100	9
	100L	160	100															
	112M	190	220															
PMG/D 3	132S	216	194	275	455	120	48	485	530	190	80	13	62	25	-	65	125	19
	132M	216	194															

Sous réserve de modifications.

GLISSIERES EN TOILE **PML**

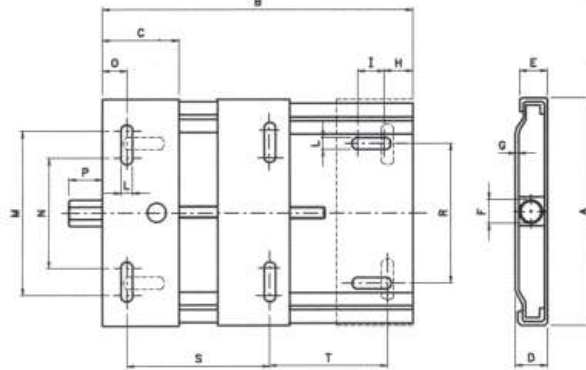

Taille	Moteur	Ajustement		Dimensions en mm														Poids kg	
		S	T	A	B	C	D	E	F	G	H	I	L	M	Q	R	U		V
PML 1	56 A	90	80																
	63M	100	70	150	210	65	27	24	17	3	25	24.5	10	100	51	20	30	80	1.5
	71M	112	58																
	80M	125	45																
PML 2	80M	125	105																
	90S	140	90	195	270	65	27	24	19	3	25	24.5	10	144	95	20	30	115	2
	90L	140	90																
	100L	160	70																
PML 3	90S	140	226																
	90L	140	226																
	100L	160	206	240	380	95	32	29	22	3	30	43	12	182	96	27	30	160	4
	112M	190	176																
	132S	216	150																
PML 4	132M	216	150																
	160M	254	156																
	160L	254	156	350	450	125	40	36	24	4	30	55	15	284	174	40	30	225	10
	180M	279	131																
	180L	279	131																

Sous réserve de modifications.